

# Sharplands Consultation



# Consultation Summary

## Overall Analysis

Question A				Question B				Question C			
A1	A2	A3	A4	A1	A2	A3	A4	A1	A2	A3	A4
12	18	62	2	12	23	52	5	5	46	19	9
12.5	18.8	64.6	2.1	12.5	24.0	54.2	5.2	5.2	47.9	19.8	9.4

## By Street Analysis

	Question A				Question B				Question C			
	A1	A2	A3	A4	A1	A2	A3	A4	A1	A2	A3	A4
Alvecote Road	0	0	1	0	0	0	1	0	0	0	1	0
% of properties	0.0	0.0	25.0	0.0	0.0	0.0	25.0	0.0	0.0	0.0	25.0	0.0
<b>Matts Close</b>	<b>1</b>	<b>1</b>	<b>6</b>	<b>1</b>	<b>1</b>	<b>5</b>	<b>2</b>	<b>1</b>	<b>1</b>	<b>5</b>	<b>2</b>	<b>0</b>
% of properties	4.0	4.0	24.0	4.0	4.0	20.0	8.0	4.0	4.0	20.0	8.0	0.0
Montrose Road South	3	4	13	0	1	5	13	0	1	14	2	0
% of properties	5.1	6.8	22.0	0.0	1.7	8.5	22.0	0.0	1.7	23.7	3.4	0.0
<b>Sharpland</b>	<b>5</b>	<b>6</b>	<b>27</b>	<b>1</b>	<b>7</b>	<b>6</b>	<b>25</b>	<b>1</b>	<b>0</b>	<b>22</b>	<b>6</b>	<b>7</b>
% of properties	7.2	8.7	39.1	1.4	10.1	8.7	36.2	1.4	0.0	31.9	8.7	10.1
Spring Close	1	1	8	0	1	3	4	2	2	2	5	0
% of properties	5.6	5.6	44.4	0.0	5.6	16.7	22.2	11.1	11.1	11.1	27.8	0.0
<b>Glenhills Blvd</b>	<b>0</b>	<b>4</b>	<b>7</b>	<b>0</b>	<b>1</b>	<b>2</b>	<b>7</b>	<b>1</b>	<b>1</b>	<b>3</b>	<b>3</b>	<b>2</b>
% of properties	0.0	0.0	9.7	0.0	1.4	2.8	9.7	1.4	1.4	4.2	4.2	2.8
Aylestone Drive	2	2	0	0	1	2	0	0	0	0	0	0
% of properties	14.3	14.3	0.0	0.0	7.1	14.3	0.0	0.0	0.0	0.0	0.0	0.0
<b>Total No of Properties</b>	<b>12</b>	<b>18</b>	<b>62</b>	<b>2</b>	<b>12</b>	<b>23</b>	<b>52</b>	<b>5</b>	<b>5</b>	<b>46</b>	<b>19</b>	<b>9</b>



City Mayor

# Consultation Summary

- 261 properties surveyed.
- Overall response rate 37% (96).
- 64.6% (62) of those that responded considered that vehicles that rat run through Sharpland and Montrose Road South are a big problem.
- Of the 62, just under half (27) of the responses came from Sharpland residents, therefore suggesting that it's a problem experienced more acutely by them.
- 54.2% (52) of those that responded thought closing the road to stop traffic going through would be the most favourable action.
- Of the 52, just under half (25) of the responses came from Sharpland residents, reinforcing the point made above.
- 47.9% (46) were in favour of closing the road at Sharpland, on the Glenhills Way side of the junction with Spring Close (so that the residents of Sharpland and people coming and going from Montrose Road South and Spring Close would have to use the Aylestone Drive entrance and the others would only be able to use Glenhills Way).
- With the exception of Aylestone Drive, the matter was classed as a 'big problem' by all streets surveyed.
- Matts Close, Montrose Road South, Sharpland and Glenhills Blvd residents mostly favoured 'mid' road closure.



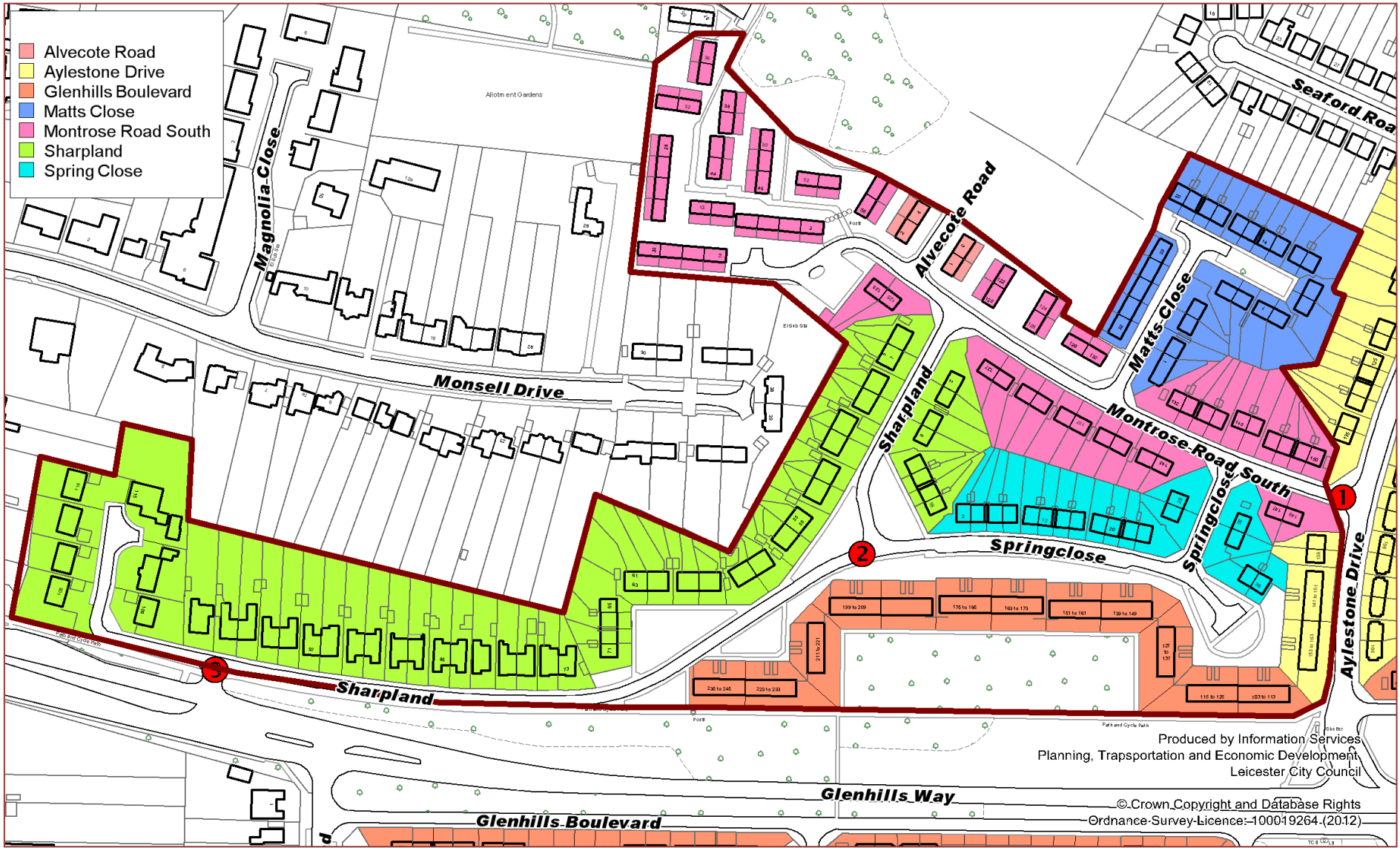

City Mayor